

G43 Clevis Grab Hook (Zinc)

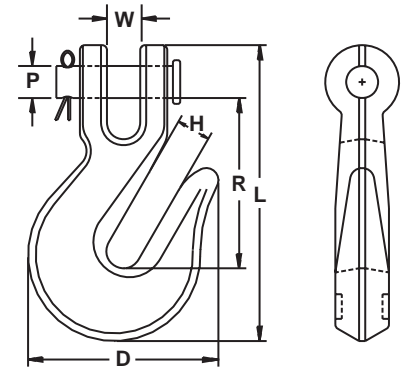

- Heat treated pins
- Hooks are heat treated and tempered
- Designs' ultimate strength equals 3 times working load limit, matching NACM specifications
- Hook embossed with trace code providing traceability through manufacturing and testing process to heat of steel
- Not to be used for overhead lifting



Size	Working Load Limit	Product Code (Zinc)	Dimensions						Weight
			W	D	H	L	R	P	
Imperial									
in.	lb.		in.	in.	in.	in.	in.	in.	lb.
1/4	2,600	61193	0.36	2.05	0.36	3.00	1.57	0.31	0.37
5/16	3,900	61293	0.42	2.41	0.44	3.56	1.98	0.38	0.63
3/8	5,400	61393	0.50	2.94	0.52	4.20	2.23	0.44	1.10
7/16	7,200	61493	0.58	3.25	0.60	4.94	2.94	0.50	1.60
1/2	9,200	61593	0.66	3.70	0.67	5.20	2.93	0.55	2.42

G43 Clevis Grab Hook (Red)



- Heat treated pins
- Hooks are heat treated and tempered
- Designs' ultimate strength equals 3 times working load limit, matching NACM specifications
- Hook embossed with trace code providing traceability through manufacturing and testing process to heat of steel
- Not to be used for overhead lifting

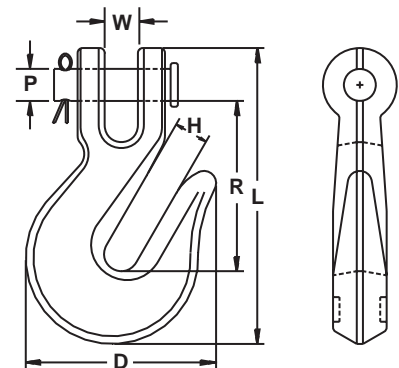

Size	Working Load Limit	Product Code (Red)	Dimensions						Weight
			W	D	H	L	R	P	
Imperial									
in.	lb.		in.	in.	in.	in.	in.	in.	lb.
1/4	2,600	61192	0.36	2.05	0.36	3.00	1.57	0.31	0.37
5/16	3,900	61292	0.42	2.41	0.44	3.56	1.98	0.38	0.63
3/8	5,400	61392	0.50	2.94	0.52	4.20	2.23	0.44	1.10
1/2	9,200	61592	0.66	3.70	0.67	5.20	2.93	0.55	1.60
5/8	13,000	61692	0.78	4.38	0.83	6.50	4.06	0.63	2.42