

# Wire Rope Attachments

## Swage Socket (open)

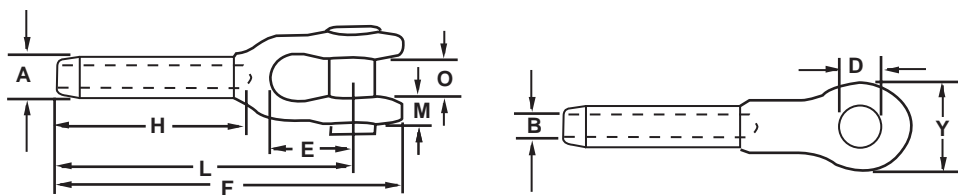

- Forged from fine grain, special bar quality C-1035 steel
- Spheroidized annealed for cold swaging
- Recommended for use on 6" x 19" or 6" x 37" IWRC regular lay wire ropes. Can also be used on galvanized bridge rope. NOT FOR USE ON FIBER CORE OR LANG LAY ROPES
- Sockets have 100% efficiency rating based on catalog strength of wire rope when properly applied



Size	Product Code	Dimensions										After Swage dia.	Weight	
		A	B	D	E	F	H	L	M	O	Y			
<b>Imperial</b>														
in.		in.	in.	in.	in.	in.	in.	in.	in.	in.	in.	in.	in.	lb.
1/4	697120	0.495	0.272	0.688	1-1/2	4-3/4	2-1/8	4	5/16	11/16	1-3/8	0.438	0.55	
5/16	697121	0.770	0.339	0.812	1-3/4	6-1/4	3-3/16	5-5/16	13/32	13/16	1-5/8	0.688	1.10	
3/8	697122	0.770	0.406	0.812	1-3/4	6-1/4	3-3/16	5-5/16	13/32	13/16	1-5/8	0.688	1.08	
7/16	697123	0.982	0.484	1.000	2	7-13/16	4-1/4	6-11/16	1/2	1	2	0.875	2.30	
1/2	697124	0.982	0.547	1.000	2	7-13/16	4-1/4	6-11/16	1/2	1	2	0.875	2.25	
9/16	697125	1.257	0.609	1.190	2-1/4	9-9/16	5-5/16	8-1/8	5/8	1-1/4	2-1/2	1.125	4.60	
5/8	697126	1.257	0.672	1.190	2-1/4	9-9/16	5-5/16	8-1/8	5/8	1-1/4	2-1/2	1.125	4.50	
3/4	697127	1.545	0.796	1.380	2-3/4	11-11/16	6-3/8	10	3/4	1-1/2	3	1.375	7.80	
7/8	697128	1.700	0.938	1.630	3-1/4	13-5/8	7-7/16	11-5/8	15/16	1-3/4	3-3/8	1.500	11.70	
1	697129	1.975	1.062	2.000	3-3/4	15-5/8	8-1/2	13-3/8	1-1/32	2	4	1.750	17.80	
1-1/8	697130	2.245	1.188	2.250	4-1/4	17-1/2	9-9/16	15	1-3/16	2-1/4	4-1/2	2.000	29.70	
1-1/4	697131	2.525	1.328	2.500	4-3/4	19-7/16	10-5/8	16-1/2	1-3/16	2-1/2	5	2.250	36.00	
1-3/8	697132	2.800	1.453	2.500	5-1/4	21-1/4	11-11/16	18-1/8	1-5/16	2-1/2	5-1/4	2.500	47.00	
1-1/2	697133	3.075	1.578	2.750	5-3/4	23-1/4	12-3/4	19-3/4	1-7/16	3	5-3/4	2.750	65.00	
1-3/4	697134	3.385	1.859	3.500	6-3/4	27-1/8	14-7/8	23	1-11/16	3-1/2	7	3.000	93.00	