

THS

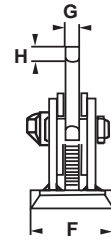

- Spring lever for locking into place
- Can be used in single or 2 leg slings
- Use lifting beams for longer plates
- Do not use with endless or 3 or 4 leg slings
- Do not exceed 60° angle when lifting
- Do not lift plates with a temperature of 120° C (250°F) or higher
- Do not use to lift stainless steel, lead or copper

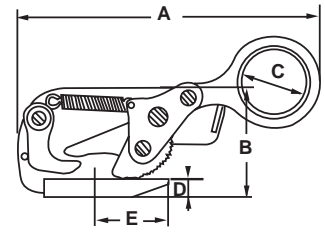

Model	Working Load Limit	Jaw Capacity	Dimensions								Weight	
			A	B	C	D	E	F	G	H		
Imperial												
	lb.	in.	in.	in.	in.	in.	in.	in.	in.	in.	in.	lb.
THS0.75	1,600	0 to 3/4	10.039	3.819	1.969	0.591	2.756	3.150	0.472	0.591	0.669	6.6
THS1.5	3,300	0 to 1-3/8	13.189	4.724	2.756	0.787	3.150	3.543	0.591	0.669	1.181	13.2
THS3	9,900	0 to 1-3/4	17.717	7.717	3.543	2.323	4.331	4.331	0.787	1.181	1.181	37.5

TSH



- Offer the best means of holding and securing loads
- High force screw threads
- Hardened steel jaws
- Swivel jaws increases grip if plate moves
- Not recommended for lifting applications

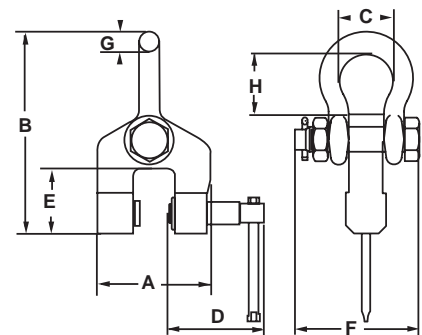

Model	Working Load Limit	Jaw Capacity	Dimensions								Weight	
			A	B	C	D	E	F	G	H		
Imperial												
	lb.	in.	in.	in.	in.	in.	in.	in.	in.	in.	in.	lb.
TSH1.5	3,300	0 to 1-1/4	5.118	10.039	2.559	4.528	2.953	5.000	1.024	3.701	1.181	15.4
TSH3	6,600	0 to 2	6.693	11.417	2.913	4.921	3.346	5.669	1.181	4.646	1.181	24.3
TSH5	11,000	0 to 3-1/8	10.039	18.504	5.118	6.890	5.315	9.449	1.969	6.890	1.181	59.5