

CP Pile Pinching Clamp

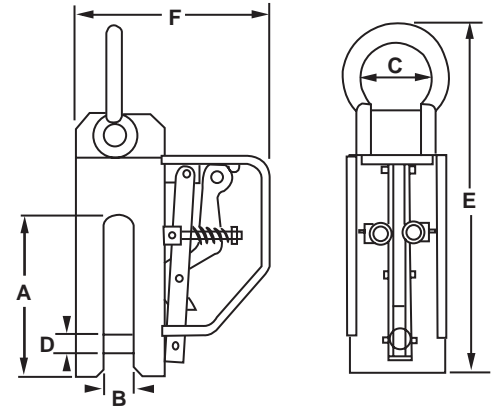

- Designed specifically for pinching sheet steel piling and have the advantage that a rope is fitted for easy release from ground level
- Perfect designed clamp for heavy construction
- Rope is fitted for easy release from the ground
- These are not designed to extract driven piles, use the PP series clamps for this



*These clamps are not designed to extract a driven pile and must NOT be used for this under and circumstance.

Model	Working Load Limit	Dimensions						Weight
		A	B	C	D	E	F	
Imperial								
	lb.	in.	in.	in.	in.	in.	in.	lb.
CP2	4,400	8.976	0.787	2.000	0.787	16.750	8.500	41.9
CP3	6,600	8.976	1.024	2.500	1.181	17.875	8.875	50.7
CP5	11,000	8.976	1.378	3.250	1.181	19.875	9.500	72.8

TTG Horizontal Girder Clamp



- Designed to lift and transport structural steel beams in horizontal position
- Fitted with a Camlok spring operated safety lock and is operated by pulling the lock upwards
- Long beams should be lifted using 2 clamps attached to opposite beam flanges

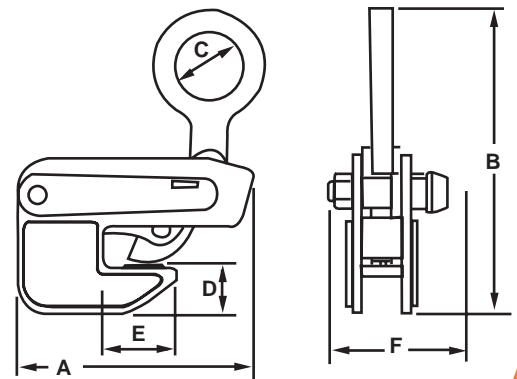

Model	Working Load Limit		Plate	Dimensions						Weight
	Min	Max		A	B	C	D	E	F	
Imperial										
	lb.	lb.	in.	in.	in.	in.	in.	in.	in.	lb.
TTG1.5	200	3,300	0 to 1-1/8	9.000	10.875	3.750	1.750	2.750	4.000	12.1
TTG3	350	6,600	0 to 1-3/8	11.125	11.625	3.125	2.125	2.875	4.500	24.3
TTG4.5*	1,000	9,900	0 to 1-1/2	12.375	13.250	3.500	2.375	3.000	4.625	32.0
TTG7.5*	1,650	16,500	0 to 1-3/4	14.500	15.000	4.375	2.500	3.625	6.625	61.7

*Not Stocked