

- A 21"
- B 10 1/2"
- \* C 4 13/16"
- \* D 10 11/16"
- \* E 2 5/16"
- F 3 1/8"
- G 6 1/2"
- \*\* H 11 3/16"
- I 1/16"
- J 1 5/8" Tread width
- K 10" Flange O.D.
- L 8 1/4" Tread O.D.
- M 2 1/4"
- N 1"
- O 3 15/16"

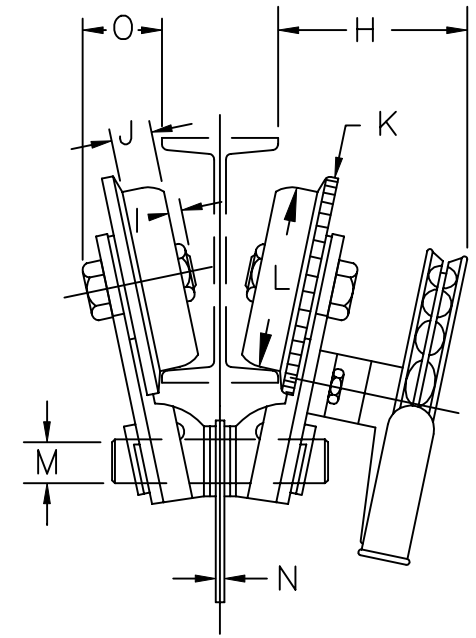
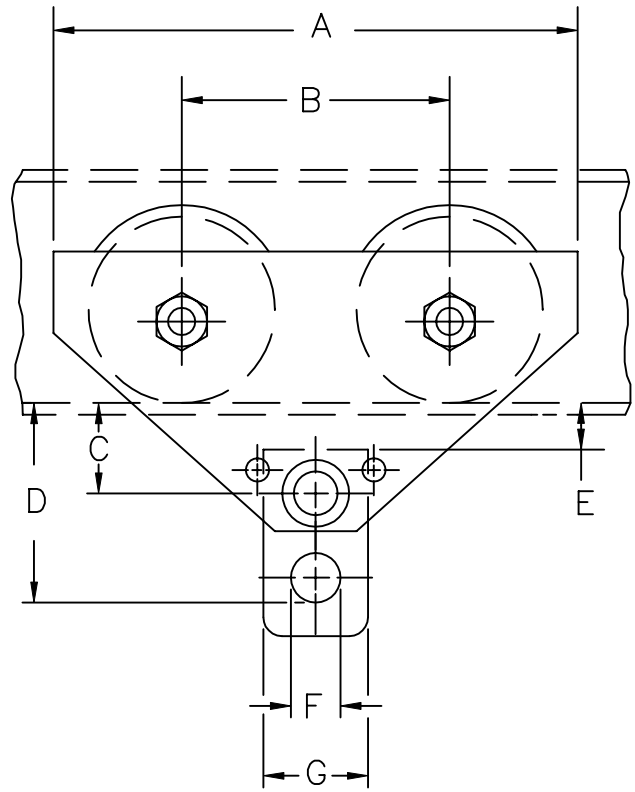

\* To wheel running surface of beam.  
 \*\* "H" applies to geared units only - For plain units o Dim. is the same for both sides of trolley.

CUSTOMER MUST TAKE INTO CONSIDERATION FLANGE WIDTH AND THICKNESS.

UNIT IS ADJUSTABLE FROM S10" TO S24" X 80# BEAM

MK.	REVISIONS	CK-DATE

8 TON "PT" TROLLEY

**CHESTER HOIST**

LISBON, OHIO

DR. RLB	TR.	CK.	AP.
SCALE NONE		DATE 6-19-00	
REF. DWG. NO.		8TONPT	
Dwg. No. CD007			